

09 Oct 2025

Landscaping Update: Planned Works Outside Kinefold House

Dear Kinefold House Residents,

We are writing to update you on the current and upcoming construction works at York Way Estate, outside of Kinefold House. This notice explains the temporary access arrangements that will be in place during the works and provides an approximate programme for the activity.

Current Works

Works are currently underway on the podium adjacent to Kinefold House, where we are stripping the existing surfacing. This is in preparation for the demolition and connection works between the existing podium and the new Block C. To ensure safety and security, the podium area will remain fenced off, and access across the podium to York Way will be unavailable during these works.

Summary of Planned Works and Approximate Time Frame

Within the next six weeks, we will carry out landscaping and waterproofing works in front of the ground-floor properties at Kinefold House.

What's being removed:

- All existing hard landscaping and surfaces
- Brick garden walls
- Concrete access ramps
- Metal railings
- Brick-built storage cupboards – the removal of these items are subject to trial pit investigations that will be carried out as part of the works. They will be retained if this is feasible alongside the new waterproofing system. It is intended that they will be replaced if removed.

Removing these elements allows us to install a new waterproofing system on the existing podium slab. We will then construct new paving and complete the front-garden landscaping.

YORK WAY ESTATE



Alternative Access Routes

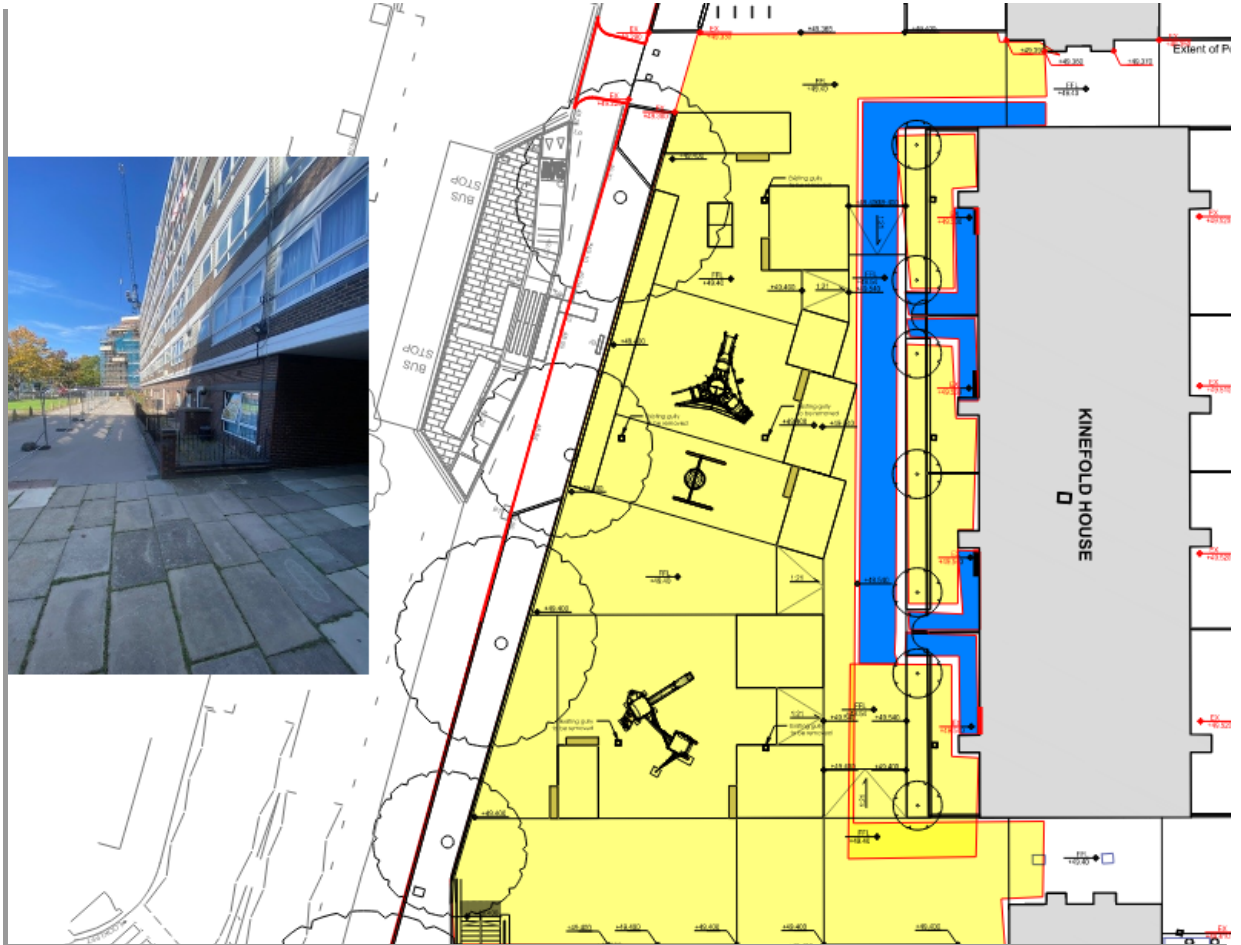

Temporary Access Routes

The revised access routes shown above are in place to ensure safe and secure movement around the estate while construction works are ongoing.

Please follow the designated paths and signage to reach York Way. We kindly ask that you avoid entering any fenced-off or restricted areas for your safety.



Ruzi Bibi
Resident Liaison Officer
07773 540 602



yorkway@higginspartnerships.co.uk



**Emergency out of hours
contact 0871 750 3001**

BRIDGE SECURITY
PART OF THE BRIDGE GROUP